



Civic Learning in Context

Civic Learning and
Engagement Conference

Monday, May 22, 2017
8:30 a.m. – 3:30 p.m.

Edward M. Kennedy Institute
Boston, Massachusetts

Map of Session Locations

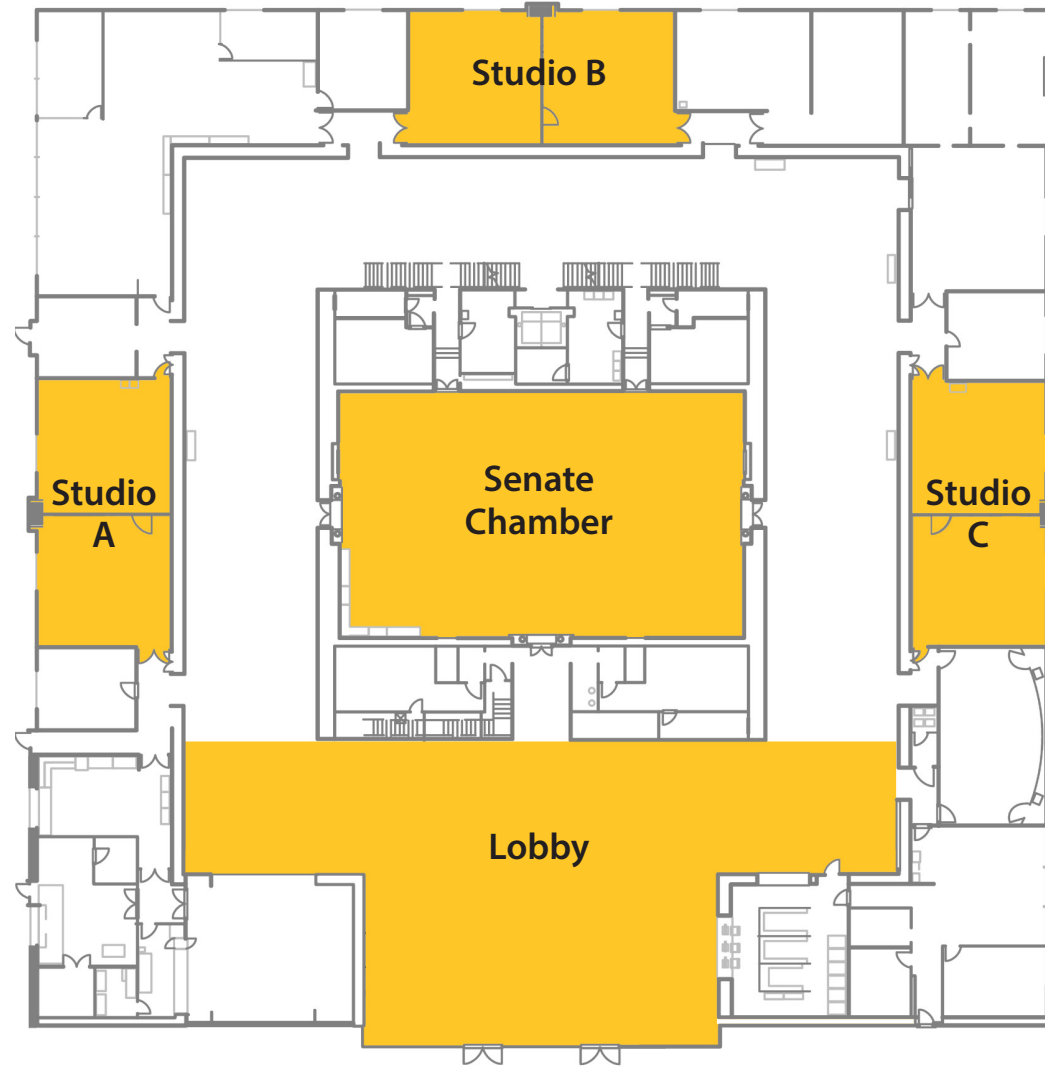

Morning Agenda

	Location ▼
8:30 a.m. Registration and Breakfast	Lobby
9:00 a.m. Welcoming Remarks Jean F. McCormack, Director, Edward M. Kennedy Institute for the United States Senate Carlos E. Santiago, Commissioner, Massachusetts Department of Higher Education	Senate Chamber
9:30 a.m. Morning Keynote Learning Beyond Campus Walls Edward M. Augustus Jr., City Manager, Worcester, Massachusetts	Senate Chamber
<div style="display: flex; align-items: flex-start;"> <div style="flex: 1;">  </div> <div style="flex: 2;"> <p>Edward M. Augustus Jr. began his political career at the age of 23 when he was elected to the Worcester School Committee, becoming the youngest person ever to hold elected office in Worcester. After serving two terms, he moved to Washington, D.C. to work in the U.S. Department of Education, where he worked to close educational achievement gaps in Latino communities.</p> <p>In 1998, Augustus returned home to Worcester to successfully run U.S. Congressman Jim McGovern's first re-election campaign, and then serve as his Chief of Staff.</p> <p>Augustus' next campaign was his own - a successful bid in 2004 to represent Worcester's 2nd District in the Massachusetts State Senate. He served two terms in the Senate, helping to pass the landmark Massachusetts Act Providing Access to Affordable, Quality, Accountable Health Care. In 2009, Mr. Augustus left the Senate to become Executive Director of the Children's Defense Fund of California, a national nonprofit children's advocacy group.</p> <p>In 2010, Augustus moved back to Worcester to once again run McGovern's re-election campaign. At the same time, he was appointed as Director of Government and Community Relations at the College of the Holy Cross, a role he served in until 2014, when he was appointed to his current role of Worcester City Manager.</p> <p>Augustus is a graduate of Saint John's High School in Shrewsbury, Suffolk University and Johns Hopkins University. He holds a master's degree in government.</p> </div> </div>	
10:15 a.m. Move to Breakout Sessions (see map on page 2)	

Follow along on Twitter!

Share your thoughts, post photos and see what other attendees are saying on twitter by using the hashtag [#CivicEdMA](#) and tagging us [@MassDHE](#)

Afternoon Agenda

Location ▼

10:30 a.m. **Breakout Sessions** *The session you chose during pre-registration is listed on your name tag.*

Session A. The Challenges of Political Learning and Engagement—Now Studio A

Nancy Thomas, Director, Institute for Democracy and Higher Education, Tufts University
Margaret McKenna, Professor of Practice, Tufts University

This session will draw upon findings from *The National Study of Learning, Voting, and Engagement* and from case studies of politically engaged colleges and universities, and will review patterns of college student voting in Massachusetts and nationally. Participants will explore how campuses can improve campus climates for political learning and engagement.

Session B. Civic Learning in Context: Reyes House Worcester and the Opioid Epidemic Studio B

Panelists: Matilde Castiel, Commissioner, Worcester Department of Health and Human Services; Co-Founder, Reyes House and Reyes Café
Rapheal Nuñez, Student, Business Administration and Economics, Worcester State University
Jonathan Oliveira, General Manager, Café Reyes

Moderator: Mark Wagner, Director, Binienda Center for Civic Engagement, Worcester State University

Reyes House opened in 2009 as the only recovery unit for Latino men in Central Mass. In 2014, the Latin American Health Alliance opened Café Reyes to create job opportunities for residents and graduates of the Reyes House, with job training assistance from Worcester State faculty and students. The panel will discuss the impact of this partnership on students and clients, and explore the role of civic engagement with Reyes House in the context of the opioid crisis.

Session C. Identifying Opportunities for Civic Learning on Campuses and Across the System Studio C

Suzanne Buglione, Dean, Lash Division of Teaching and Learning, Bristol Community College
Cynthia Lynch, Director, Center for Civic Engagement, Salem State University
John Reiff, Director, Civic Learning and Engagement, Massachusetts Department of Higher Education

Participants will review Fall 2016 civic learning data, and the process of campus data collection in the first year of implementation. In an interactive and participatory conversation, we will discuss our contention that while quantity matters (we hope to involve every undergraduate in civic learning), quality matters even more (we want this designation applied to courses where the design reflects thoughtful consideration to achieve civic learning outcomes).

Session D. Immersive Civic Learning: The Senate Immersion Module Senate Chamber

Caroline Angel Burke, Vice President, Education, Visitor Experience and Collections, Edward M. Kennedy Institute for the United States Senate

This interactive session will preview the Edward M. Kennedy Institute's simulation program. This simulation, presented in the Senate Chamber, offers participants the opportunity to practice the processes and skills necessary to make laws, and gain a window into civic participation. Attendees will work through a portion of the simulated bill-building process and will discuss the Institute's approach to sparking civic learning by exposing students to the legislative process.

11:45 p.m. **Move to Lunch**

12:00 p.m. **Lunch (Networking)**

1:00 p.m. **Afternoon Keynote**

Civic Learning in the 21st Century Academe: Beware of Shrinking Imagination

Timothy K. Eatman, Dean, Honors Living Learning Community, and Professor, Urban Education, Rutgers University; Faculty Co-Director, Imagining America: Artists and Scholars in Public Life.



Timothy K. Eatman is the inaugural dean of the Honors Living Learning Community and professor of urban education at Rutgers University Newark. He also serves as faculty co-director of “Imagining America: Artists and Scholars in Public Life,” a national consortium of over 100 higher education institutions and community based partners working at the nexus of the cultural disciplines (humanities, arts and design) and community engagement.

Eatman is an educational sociologist who researches questions of equity in higher education and the larger society. He has published in such venues as the *Journal of Educational Finance*, *Readings on Equal Education*, *Diversity and Democracy*, and *The Huffington Post*, and has written several other book chapters and reports including the widely cited *Scholarship in Public: Knowledge Creation and Tenure Policy in the Engaged University*. He sits on the editorial board of *University of Michigan Press - The New Public Scholarship* book series, *Urban Education*, *Diversity*, and *Democracy* and reviews for several scholarly journals and publications.

Eatman is a faculty member for The Association of American Colleges & Universities Summer Institute on High Impact Practices and a member of the Advisory Panel for the Carnegie Engagement Classification for Community Engagement. In 2010, Eatman earned the Early Career Research Award from the International Association for Research on Service Learning and Community Engagement, and was elected to its board of directors in 2016.

Eatman received his Ph.D. in educational policy studies at University of Illinois at Urbana-Champaign, a master's degree in college student development at Howard University, and a bachelor's degree in early childhood development at Pace University.

2:00 p.m. **Move to Breakout Sessions (see map on page 2)**

2:15 p.m. **Breakout Sessions** *The session you chose during pre-registration is listed on your name tag.*

Session A. Finding the Civic Learning in Your Classroom

Studio A

Barbara Canyes, Executive Director, Massachusetts Campus Compact

Danielle Leek, Director of Professional Learning, National Campus Compact

This workshop is designed for faculty who seek creative approaches for building civic learning into their courses. Activities will focus on approaches to accomplishing the Civic Learning outcomes in a way that complements, rather than supplants, current course content. Participants will leave the workshop with multiple strategies and resources that can be used in any discipline, and that are specific to civic issues in Massachusetts. Topics will include assignment ideas, learning objectives, and techniques for grading.

Session B. Immersive Civic Learning: Conference Committee

Studio B

Sarah Yezzi, Education Manager, Edward M. Kennedy Institute for the United States Senate

In our current political landscape, it is becoming more imperative and relevant to understand models of cooperation and mutually beneficial negotiation in a legislative context. This interactive session will preview the Edward M. Kennedy Institute's Conference Committee simulation program and its focus on the art and skills of negotiation

Session C. What Happens to Students When They Take Our Courses? Tools for Assessing the Impacts of Civic Learning Courses on Students

Studio C

Suzanne Buglione, Dean of Lash Division of Teaching and Learning, Bristol Community College

John Reiff, Director, Civic Learning and Engagement, Massachusetts Department of Higher Education

This session will explore tools for assessing the impact of civic learning on retention, completion, and student learning, and will explore how one campus has effectively tracked these impacts. We'll then briefly consider the broad range of possible civic learning outcomes—the knowledge, intellectual skills, and practical skills that citizens need for informed and effective participation in civic and democratic life, and an understanding of the social and political values that underlie democratic structures and practice. In an interactive format, we'll also examine two rubrics created by the DHE for campuses and individual faculty to assess student learning of Civic Knowledge and Civic Values.

Session D. What's the Story on Civic Engagement? Student Development, Campus Leadership and Faculty Support

Senate Chamber

Timothy K. Eatman, Dean, Honors Living Learning Community, and Professor, Urban Education, Rutgers University; Faculty Co-Director, Imagining America: Artists and Scholars in Public Life.

Cynthia Lynch, Director, Center for Civic Engagement, Salem State University

Mark Wagner, Director of the Binienda Center for Civic Engagement, Worcester State University

Massachusetts' prioritization of civic learning and engagement holds important implications for campus structures, campus organizing, and faculty/staff/student interaction—especially in the current social and political context. In this interactive session, two lightning provocations will be offered by co-facilitators as a springboard to explore critical civic engagement issues, such as approaches that promote students' desire to engage and their interest in learning advocacy skills to leverage change. Participants will use a story circle methodology to deepen understanding and reflect on practice, and we'll endeavor to explore how we might better facilitate student growth and learning, engage in effective leadership, and support faculty. Participants will leave with a toolkit of resources.

3:30 p.m. **Program Ends**

Thank You

Conference Planning Team

Suzanne Buglione, Dean of Lash Division of Teaching and Learning, Bristol Community College

Caroline Angel Burke, Vice President, Education, Visitor Experience and Collections, Edward M. Kennedy Institute for the United States Senate

Barbara Canyes, Executive Director, Massachusetts Campus Compact

Danielle Leek, Director of Professional Learning, National Campus Compact

Cynthia Lynch, Director, Center for Civic Engagement, Salem State University

Mark Wagner, Director of the Binienda Center for Civic Engagement, Worcester State University

John Reiff, Director, Civic Learning and Engagement, Massachusetts Department of Higher Education

Christine Williams, Director of Strategic Initiatives, Massachusetts Department of Higher Education

Sarah Yezzi, Education Manager, Edward M. Kennedy Institute for the United States Senate

Our Partners



Campus Compact
Massachusetts

Massachusetts Campus Compact is a nonprofit coalition of more than 60 college and university presidents committed to developing the civic engagement skills of students, building partnerships with the community, and integrating civic engagement with teaching and research.

www.masscampusimpact.org

**EDWARD M.
KENNEDY
INSTITUTE**

The Edward M. Kennedy Institute for the United States Senate is dedicated to educating the public about the important role of the Senate in our government, encouraging participatory democracy, invigorating civil discourse, and inspiring the next generation of citizens and leaders to engage in the civic life of their communities.

www.emkinstitute.org

Post-Conference Evaluation

Don't forget to fill out the post-conference survey! Your feedback will help us make the next conference even better.

www.mass.edu/CivicEdEvaluation



MASSACHUSETTS
Department of
Higher Education

One Ashburton Place, Room 1401, Boston, MA 02108

(617) 994-6950 • www.mass.edu



@MassDHE